

# Lena

Therapy couch for dialysis  
and chemotherapy



**NAMRØL**  
GROUP

## Ideal for Dialysis, Chemotherapy or Blood Sampling



Seated position



Bed position, flat position



Trendelenburg and shock position



Relax position with infusion holder

### THERAPY COUCH FOR DIALYSIS AND CHEMOTHERAPY

LENA a Therapy chair that represents a brand new technological advancement for the specific requirements of dialysis. Equipped with 3 or 4 electric motors, an easy-to-clean anatomic mattresses and non-toxic, medical upholstery.

Upholstered in treated polyurethane, high density padding offering great comfort and durability.

The motors, the home position and the 2 memories totally programmable can assume any position and height. Due to these movements, the professional can carry out his work in complete comfort.

Upholstered armrests with raising/lowering synchronised with back rest, independently retractable.

The proximity to floor level and the removable armrests provide ease of access for the patient.

Legrest with feet support, retractable, with gas spring controlled high and low system.

Stable, safe and functional chassis.

Optimum designed base allowing ease of access from any angle.

#### ARMRESTS

For every specialty the perfect solution: armrests that rotatable and can be folded upwards, optional armrests that tiltable or armrests with height adjustment.

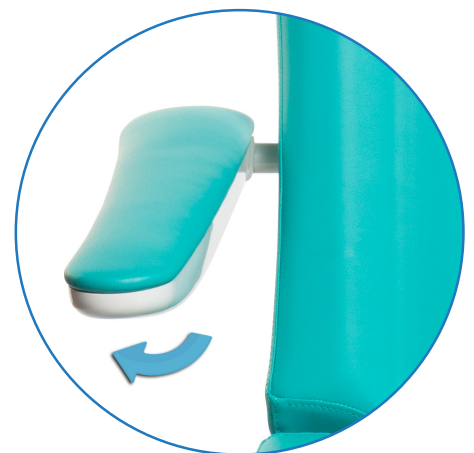

#### HAND CONTROL CHAIR

Simple operation, internationally understandable symbols; keys for basic settings for seated, relaxation, flat bed and Trendelenburg positions.

It is equipped with two independent memories to recall the stored positions, plus the return to the initial home position button.



# Lena



## OPTIONALS AND ACCESORIES



### INFUSION HOLDER

Stainless steel holder  
with 2 hooks.

## TOP QUALITY COMPONENTS

Motors



Upholstery



Gas springs

**STABILUS**

### WHEELS

#### WITH BRAKE

Mobility and braking  
10 cm. castors.



### OVERCHAIR TABLE

It allows the patient to perform  
a multitude of tasks whilst  
remaining in a seated position



### PAPER HOLDER

Ergonomic paper holder, easy  
assembly (max. length 59 cm,  
12,5 cm diameter)

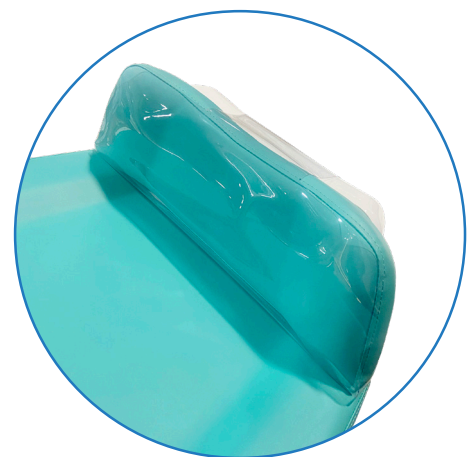

### PROTECTIVE COVER

Protective cover in transparent  
vinyl for footrest.

# Lena

## TECHNICAL SPECIFICATIONS

|                       |                     |
|-----------------------|---------------------|
| Manufactured by       | Namrol Medical S.L. |
| Model                 | SN-88*              |
| Identification number | On CE Plate         |
| Type                  | Electromechanic     |
| Power Supply          | 115 / 230 V         |
| Frequency             | 50/60Hz             |
| Operating Voltage     | 24 Volts            |
| Amps                  | 3,0 A               |
| Power                 | 120 W               |
| Memories              | 2                   |

## CAPACITY

|               |        |
|---------------|--------|
| Liftable load | 220 Kg |
| Chair weight  | 82 Kg  |

## FINISHES

|                  |                  |
|------------------|------------------|
| Cover Plastics   | ABS              |
| Upholstered      | SKAI             |
| Paint            | Bylayer painting |
| Base with wheels | Gray Wheels      |

## MOVEMENTS

|                           | 3 MOTORS   | 4 MOTORS   |
|---------------------------|------------|------------|
| Height adjustment         | Electrical | Electrical |
| Tilt adjustment           | Electrical | Electrical |
| Back adjustment           | Electrical | Electrical |
| Legrest adjustment        | Gas Spring | Electrical |
| Link legrest and backrest | ✓          | Memories   |

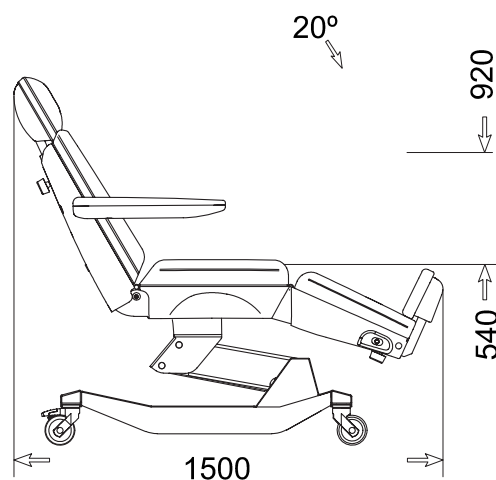
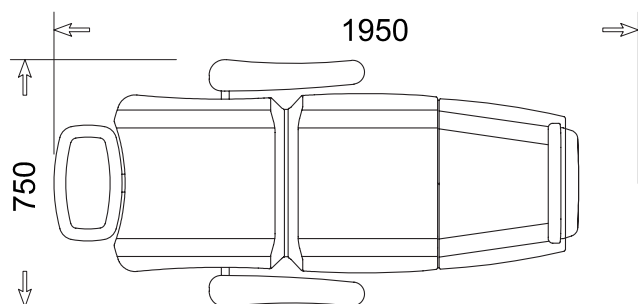

## COLORS

HIGH QUALITY MATERIAL. LONG DURABILITY, PLEASANT TO THE TOUCH AND RESISTANT TO BLOOD, AS WELL AS DISINFECTION PRODUCTS.

**NAMRØL**  
GROUP

C. Drets Humans, 17-19  
08870 Sitges, Barcelona, Spain  
www.namrolgroup.com  
export@namrol.com  
Tel. : +34 938 113 688



Color swatches are approximate and may vary slightly due to printing.